

GENEVA
Toilet Paper Holder
MODEL # 40156

Pure Freude an Wasser

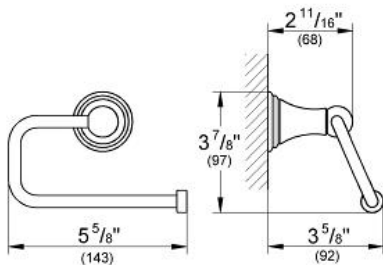

GROHE America, Inc | 200 North Gary Avenue, Suite G, Roselle, IL 60172
Phone: +1 (800) 444-7643 | Fax: +1 (800) 225-2778 | us-customerservice@grohe.com



Product Description:
Toilet Paper Holder

Standard Specification:

- GROHE StarLight® finish

Applicable Codes & Standards:

- Energy Policy Act of 1992
- ASME A112.18.1/CSA B125.1

Color:

- 40156 000 chrome
- 40156 BE0 sterling / brilliant nickel
- 40156 EN0 brushed nickel
- 40156 ZB0 oil rubbed bronze